



31 Bushlands Avenue Gordon NSW

4  2  3 

Discover "SOMERTON" - a gem nestled in the heart of Gordon. Set in magnificent private level grounds enjoying a perfect rear-to-north aspect. Just a 10-minute stroll from Gordon station and Village shops, you'll find the epitome of convenience and accessibility at your doorstep. Despite its central locale, the home offers a sanctuary of peace and privacy.

Step onto the wide porch, where the grandeur of the past embraces you. The entry vestibule leads you to a spacious double lounge adorned with an open fireplace. The enclosed verandah invites you to unwind and relish in the home's timeless beauty. In the formal dining room, echoes of laughter and celebrations past mingle with the promise of family gatherings and memorable meals to come.

Type : House
Price : \$1,575 pw
View : <https://www.luschwitz.com.au/8689854>



Leasing Team
(02) 9449 5511

[For full version visit the website](#)

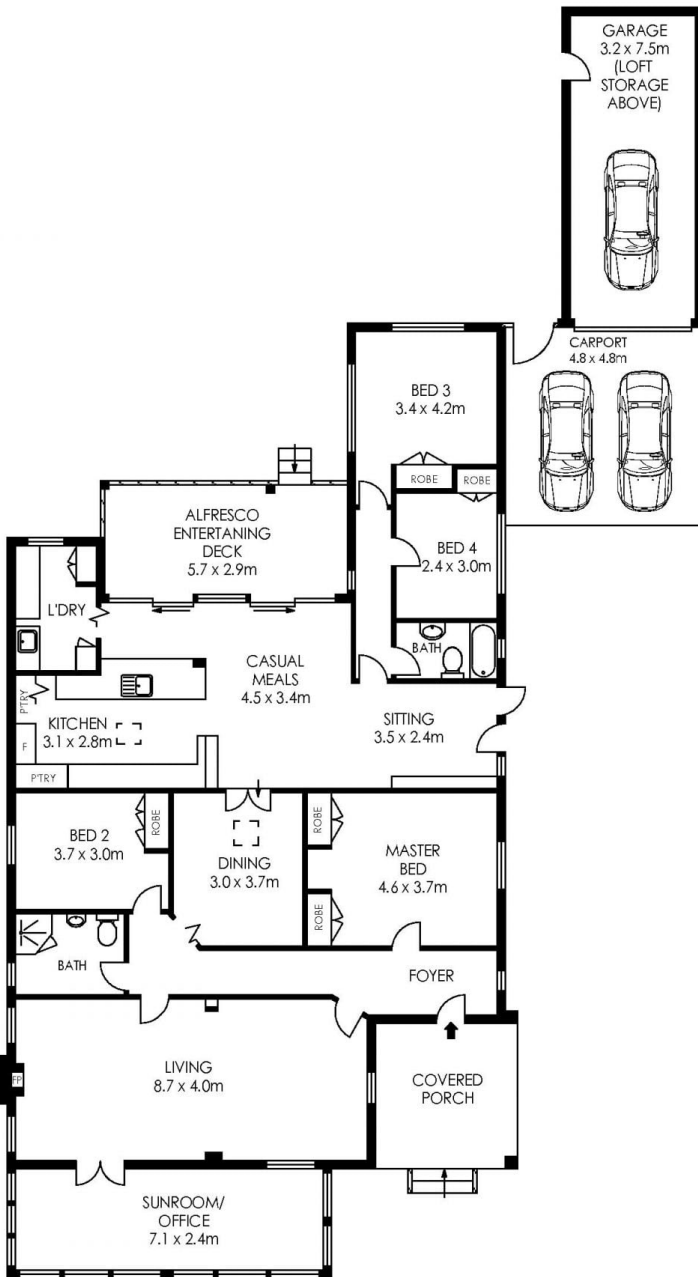

**SITE PLAN
(NOT TO SCALE)**

APPROX. RESIDENCE AREA = 199 m²
 APPROX. LAND SIZE = 948 m²



PLANS SHOWN ONLY INDICATIVE OF LAYOUT. DIMENSIONS ARE APPROXIMATE.

"Somerton" 31 Bushlands Ave, Gordon



Luschwitz

© 2026 - Luschwitz Real Estate