



6 Rushall Street Pymble NSW

4 🏠 3 🚗 2 🚗

Architect-designed and quality built, this stylish, spacious and modern home is nestled on a quiet, level block in East side Pymble. Exceptional attention to detail can be found throughout the quality finishes to the full brick and concrete slab construction. The free-flowing floor plan includes a stunning open-plan kitchen, spacious family room plus a separate formal lounge and dining all opening to alfresco entertaining, level lawns and established gardens. Accommodation consists of 4 generous bedrooms (main with ensuite and walk-in) plus a separate study downstairs and 3 modern bathrooms. Further features include a sunny, private pool, double garaging with great storage and internal access, r/c air-conditioning, gas fire place and electric gates. The convenient location, close to Pymble Public School, Pymble train station and Pymble Ladies

Type : House
Land Size : 776 sqm
View : <https://www.luschwitz.com.au/8120105>



Josh Luschwitz
 +612 9449 5511



Sue Hodges
 +612 9449 5511

[For full version visit the website](#)

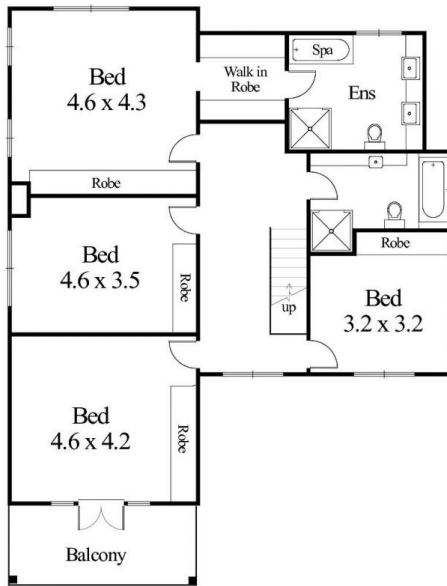

FIRST FLOOR



6 Rushall Street, Pymble

Disclaimer : K & S Smith-White ABN 84 553 107 368 Trading as NORTHSIDE FLOORPLANS Pymble - Hornsby Tel. 9144 2474; Mob. 0427 442 474
This floor plan serves only as a guide for promotional purposes and should not be sealed or relied upon for any specific detail. No liability will be accepted.