



3/1 Hipwood Street Kirribilli NSW

1  1  1 

Set in the boutique 'Parkview' block of just 12, this light filled corner apartment enjoys a tranquil outlook over Milson Park. This is an ideal entry point to this sought after neighbourhood for owner occupiers and investors alike with undercover parking and the convenience of being just 550m walk to Milsons Point station, North Sydney ferry wharf and local shops, cafes and restaurants.

- Wall to wall windows to maximise the view and natural light
- Separate kitchen with gas cooking
- Generous open plan living and dining enjoying the leafy outlook
- Spacious double bedroom with built-in robes
- Large bathroom with room for washer/dryer

Type : Apartment
Building Size : 50 sqm
View : <https://www.luschwitz.com.au/7532036>



Josh Luschwitz
 +612 9449 5511



Dane Preston
 0448 996 676

[For full version visit the website](#)

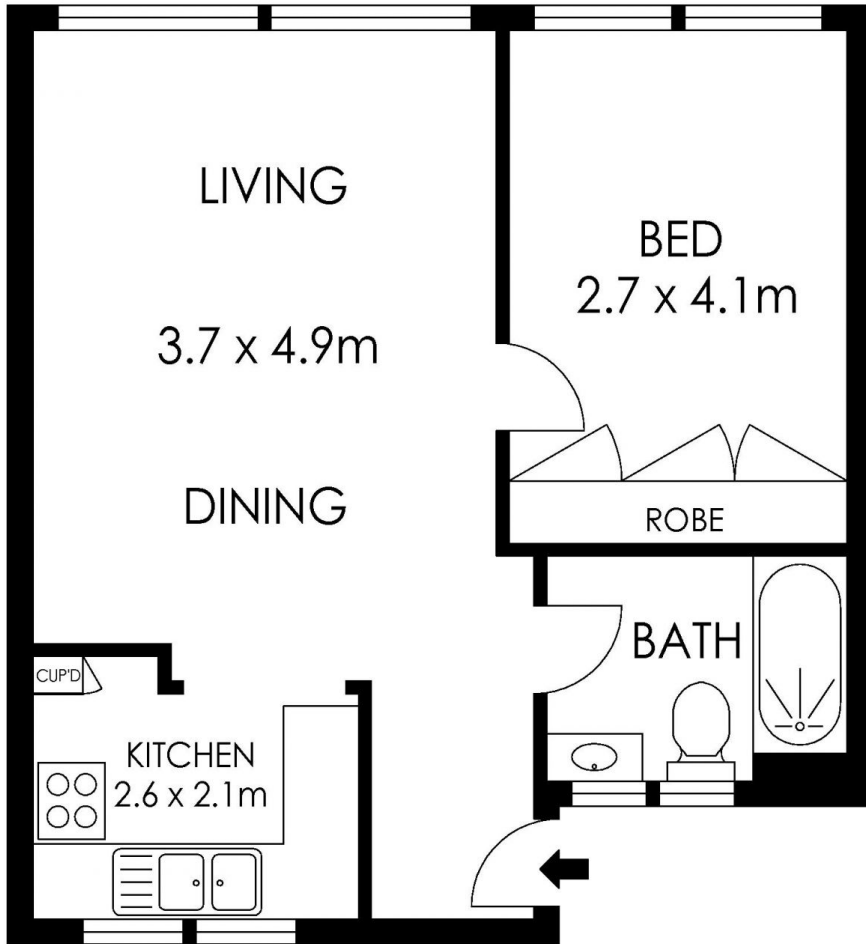

COVERED
CARSPACE
3.0 x 5.1m

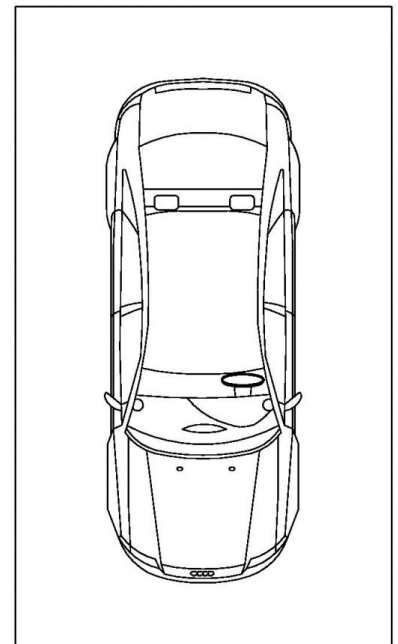

GROUND LEVEL

ELEVATED GROUND LEVEL



PLANS SHOWN ONLY INDICATIVE OF LAYOUT. DIMENSIONS ARE APPROXIMATE.

3/1 Hipwood Street, Kirribilli



Luschwitz

© 2026 - Luschwitz Real Estate