



17 Duneba Avenue Pymble NSW

3  2  2 

Classic brick and tile Bungalow on a beautiful level 841M corner block. Very quiet exclusive location convenient to everything. Comprises 3 bedrooms, 2 bathrooms, open plan lounge/dining plus a separate casual family living room. Laundry. Large lock-up garage plus carport.

Type : House
Land Size : 841 sqm
View : <https://www.luschwitz.com.au/4569958>

Located just across the road from the West Gordon Shops, which include a bakery, butcher and the popular Sawmill Café, the home is quiet yet offers easy access to Ryde Road for those heading to Macquarie Park, the Northern beaches or beyond. It's also just a short stroll to the bus stop with regular services to Gordon Station and Macquarie Uni and walking distance to Kuringgai fitness and aquatic centre. The sought after Gordon West Public School is just 600m away and it's only a short drive to nearby,



Josh Luschwitz
+612 9449 5511

[For full version visit the website](#)

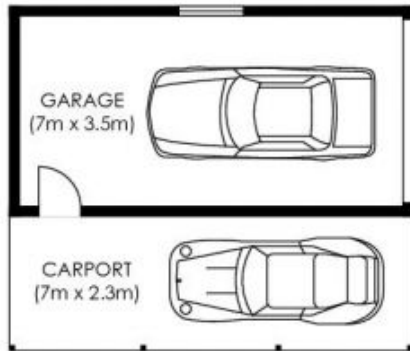

SITE PLAN
not to scale

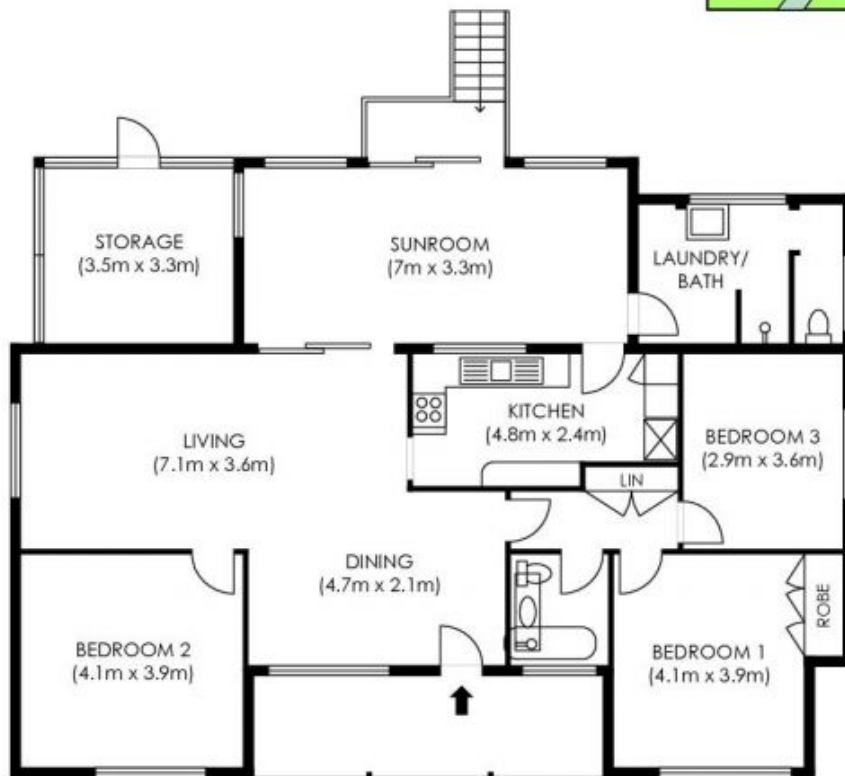

INTERNAL AREA
APPROX = 163 sqm

Plans are intended as a guide only. No representations or warranties of any nature whatsoever are given or intended and any person using this information should always rely on their own enquiries.

j interiors - real estate floor plans. jinteriors.info@gmail.com

