



### 32 Park Crescent Pymble NSW

5 🚗 2 🚗 3 🚗

Impeccably presented beautifully restored classic 1920's Californian Bungalow in a tightly held and highly prized location. Impressive circular drive approach set in commanding high side position with perfect rear-to-north aspect and picturesque views over Robert Pymble Park.

A home of immense appeal and charm lovingly restored combining character old world appeal with easy care modern living. Set in magnificent established manicured gardens the residence has many fine features including sandstone footings and pathways, lovely craftsman timber work, high ornate ceilings, polished timber floors, marble fireplace, large light filled rooms and excellent flow to private alfresco dining and entertaining.

**Type** : House  
**Price** : \$ 3,550,000  
**Building Size** : 286 sqm  
**Land Size** : 1018 sqm  
**View** : <https://www.luschwitz.com.au/4569933>



**Josh Luschwitz**  
 +612 9449 5511



**John Luschwitz**  
 +612 9449 5511

[For full version visit the website](#)

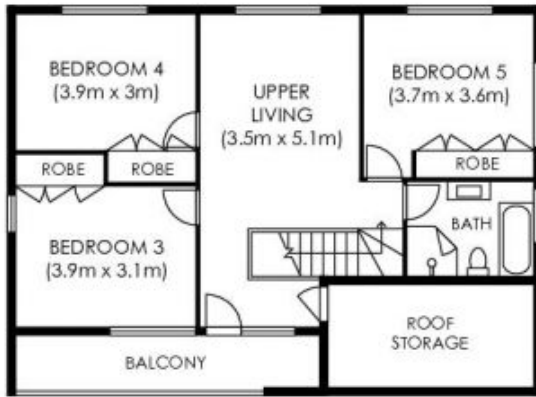

**FIRST FLOOR**



**GROUND FLOOR**



**INTERNAL AREA  
APPROX = 286 sqm**

Plans are intended as a guide only. No representations or warranties of any nature whatsoever are given or intended and any person using this information should always rely on their own enquiries.

j interiors - real estate floor plans. jinteriors.info@gmail.com