



14 Reynolds Street Pymble NSW

3  1  1 

This is a fantastic opportunity to secure 573sqm of level land in prime, East side Pymble and create your low maintenance, easy care dream home (STCA). Capitalise on the whisper quiet location surrounded by quality homes and convenient to Pymble shops, station and popular schools via laneway access to Station street. Surrounded by pretty, established gardens, the original cottage has fallen into disrepair and now presents a blank slate for those looking to re-build or extensively renovate. Be quick to come and explore the possibilities of this rare offering.

Type : House
Price : \$ 1,691,000
Land Size : 573 sqm
View : <https://www.luschwitz.com.au/4569903>



Josh Luschwitz
 +612 9449 5511



John Luschwitz
 +612 9449 5511

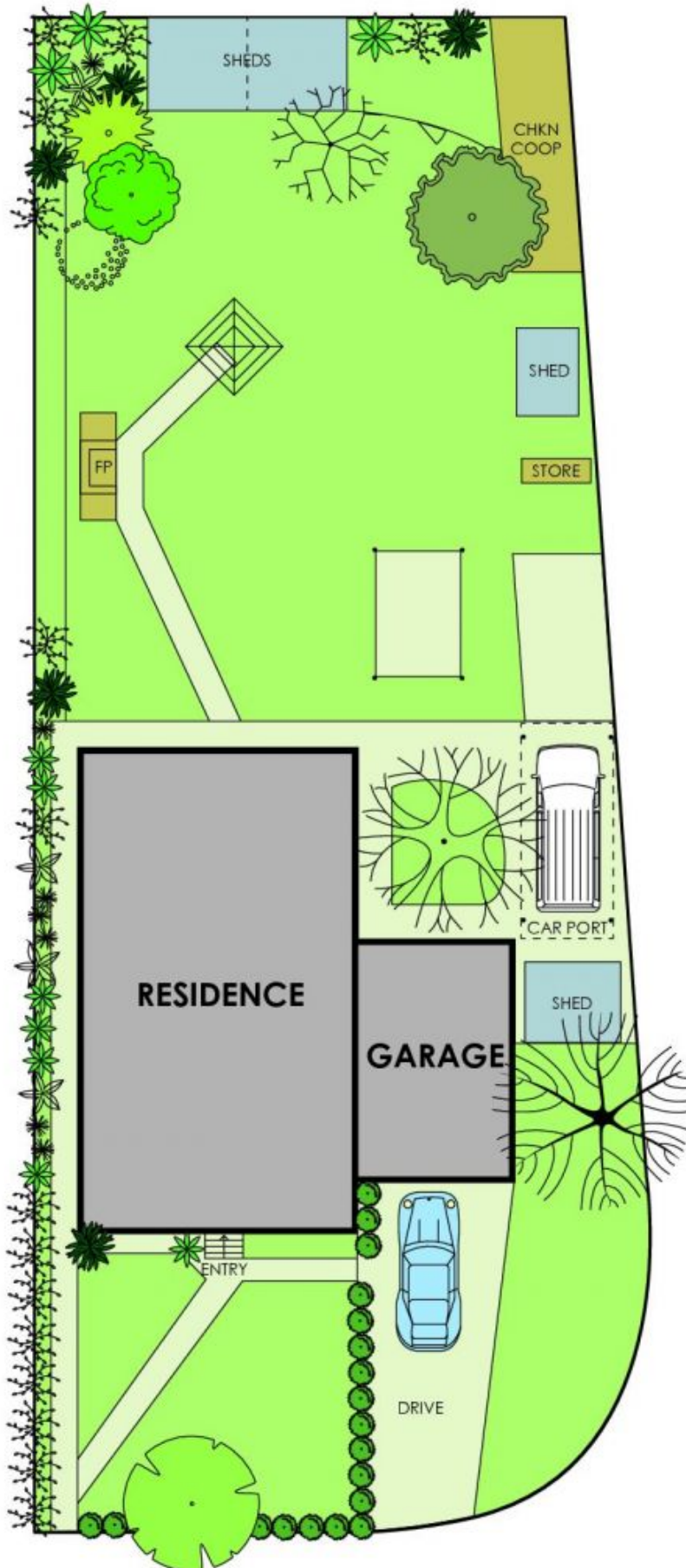

Plans are intended as a guide only. No representations or warranties of any nature whatsoever are given or intended and any person using this information should always rely on their own enquiries. [j interiors - real estate floor plans. www.jinteriorsinteriordesign.blogspot.com](http://www.jinteriorsinteriordesign.blogspot.com)

