



### 39 McIntosh Street Gordon NSW

5 🛏 2 🚿 1 🚗

Offered for the first time in 33 years and with just 3 owners since its construction in the 1930s, this beloved family home offers character and quality seldom found.

**Type** : House

**View** : <https://www.luschwitz.com.au/4569880>

Surrounded by some of the suburb's best Real Estate, the home enjoys an exclusive East side address just a few minutes' walk from Gordon rail station (one of the few North Shore stations with a lift and an overhead booking office) and bus interchange, shops, cafes and restaurants, Ravenswood School and parks and recreation facilities. Killara High School and Gordon East Public School catchments.



**Josh Luschwitz**  
 +612 9449 5511



**John Luschwitz**  
 +612 9449 5511

The house includes charming original features such as tallow wood floors and lead light windows and its character

[For full version visit the website](#)



# Luschwitz

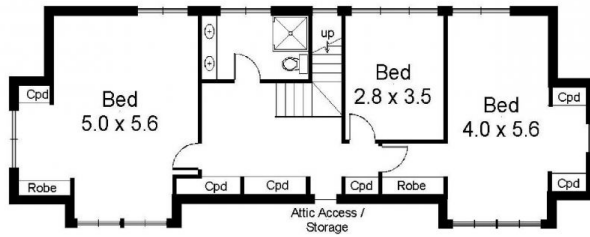

FIRST FLOOR



GROUND FLOOR

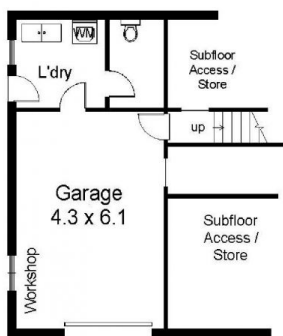

LOWER GROUND

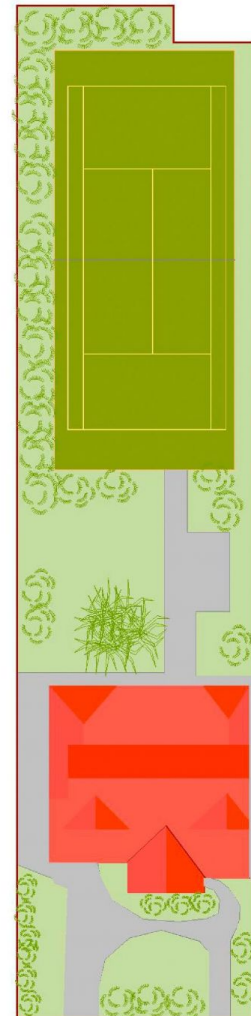

SITE PLAN

## 39 McIntosh Street, Gordon

INTERNAL FLOOR AREA (approx) 343 m<sup>2</sup> :37 sq

**Disclaimer** : K & S Smith-White ABN 84 553 107 368 Trading as NORTHSIDE FLOORPLANS Pymble - Hornsby Tel. 9144 2474; Mob. 0427 442 474  
This floor plan serves only as a guide for promotional purposes and should not be scaled or relied upon for any specific detail. No liability will be accepted.  
Prospective purchasers should make and rely upon their own inquiries to determine the accuracy of all measurements and features.