



11/1012 Pacific Highway Pymble NSW

4 🛏 2 🚿 2 🚗

Set at the rear of a small boutique block just moments stroll to Pymble train station, shops and Pymble Ladies College, the flexible floor plan of this beautifully presented apartment offers space seldom found - great for a large or extended family or for those who simply need a bit more room. Accommodation consists of 4 spacious bedrooms including one with a new ensuite bathroom. The fabulous new kitchen with breakfast bar and European appliances adjoins a modern, open plan lounge/dining and wrap-around balcony with sunny outlook across the treetops. Large separate lounge could also serve as a media room/study or home office. New internal laundry plus renovated main bathroom with separate toilet and fantastic storage both inside and in the massive approx 35 sqm separate, lock-up storage room. 2 car spaces, reverse

Type : Apartment

View : <https://www.luschwitz.com.au/4569603>



Josh Luschwitz
+612 9449 5511

[For full version visit the website](#)

Disclaimer: Purple Planner Pty. Ltd. A.B.N. 83 193 607 460
Trading as NORTH-SIDE FLOORPLANS ROSSBY VIC
Tel: 0344 2143 Fax: 0462 372 101
This floor plan serves only as a guide for promotional purposes and should not
be relied upon for any specific detail. No liability will be accepted. 12/11

Internal Floor Area approx 105 m²
(including Storage Area, not including Balconies, Carcavase etc.)

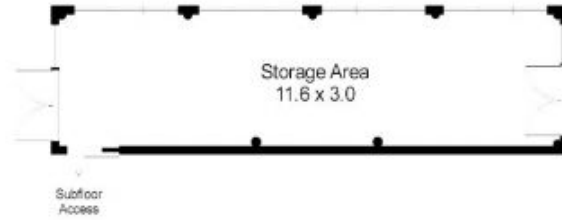

'Wellington Court' 11 / 1012 Pacific Highway Pymble

